

# Drone and Transmitter Overview

## Drone

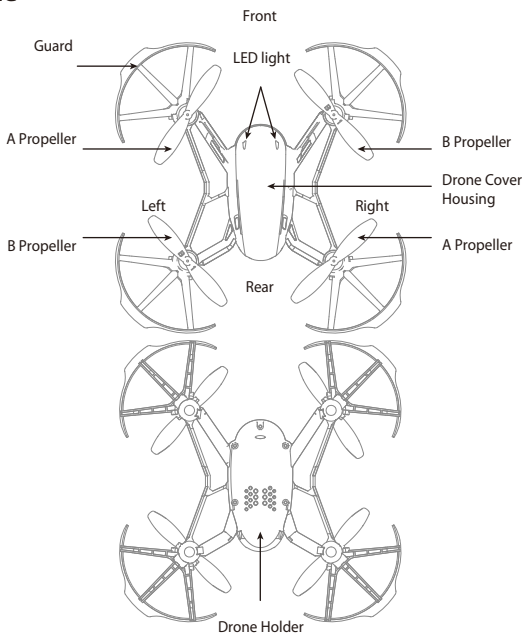

## Specification

Drone Size	140x140x35mm	Drone Battery	3.7V 450mAh
Drone Weight	47.5g	Charging Time	50 to 60mins
Flying Time	5 to 6 mins	Max Flying Distance	20 to 30m

# Exploded View

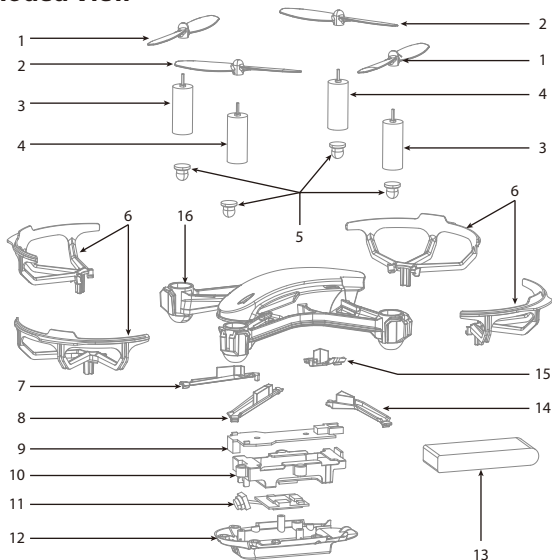

No.	Name	No.	Name
1	B Propeller (counterclockwise)	9	Receiver Board
2	A Propeller (clockwise)	10	Battery box
3	Counterclockwise Motor (Black and White wire)	11	Camera Board
4	Clockwise Motor (Red and Blue wire)	12	Drone bottom housing
5	Cushion	13	Battery
6	guard	14	Left Rear LED Cover
7	Right Front LED Cover	15	Right Rear LED Cover
8	Left Front LED Cover	16	Drone Cover Housing

# Transmitter

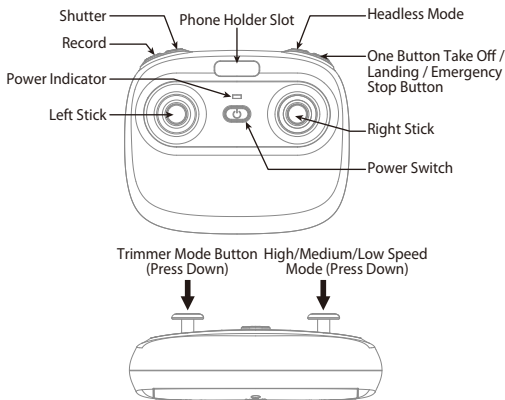

## Brief Introduction for Button Functions

<b>Left Stick:</b> Move the Stick to forward / backward / left / right to fly the drone up / down / turn left / turn right.
<b>Right Stick:</b> Move the Stick to forward / backward / left / right to fly the drone forward / backward / left / right.
<b>Power Switch:</b> Turn on/Off the controller.
<b>Shutter:</b> Press down the button, start to photograph.
<b>Record:</b> Press down the button, start to record video.
<b>Headless Mode:</b> Press to enter Headless Mode. Press again to end Headless Mode.
<b>One Key Taking Off/Landing/Emergency Stop:</b> Press once and the drone will take off automatically. Press again and the drone will land automatically. Press and hold the button for more than 1 second for an emergency landing. The drone propellers will stop and land immediately.
<b>High / Medium / Low Speed button:</b> Press to switch to High /Medium/ Low Speed.
<b>Trimmer Mode Button:</b> Press this button and move the right stick to the required trimmer direction, then it will adjust the direction accordingly. Release the stick to end trimmer mode.

## Battery Installation

Open the battery cover of the transmitter, insert 4 AA batteries following the polarity indicators ( Picture 1, battery is not included) and then screw it.(Picture 2)

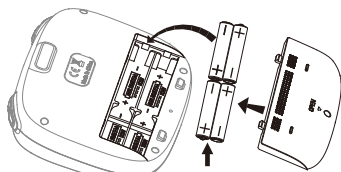

Picture 1

Alkaline Battery

Battery Cover



Picture 2

**Notice:**

1. Make sure the electrodes are correct.
2. Do not mix new batteries with the old ones.
3. Do not mix different kinds of batteries.
4. Do not charge the non rechargeable battery.

## Parts installation

### Charging Instruction for Drone Battery

1. Connect the drone battery with USB cable first and then choose one of the method as below picture shown to connect with USB plug.
2. The red USB indicator light keeps bright when charging and the light turns green when fully charged.

**\* For faster charging, it is recommended to use an adapter with 5V 2A output current (not included) to charge the battery.**

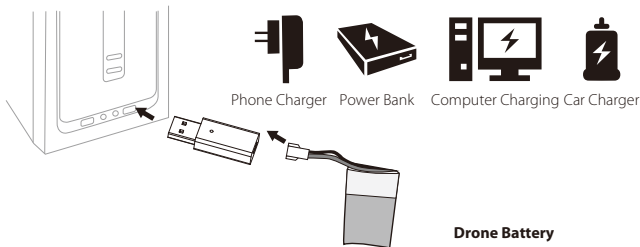

Drone Battery



#### Li-Po Battery Disposal & Recycling

Wasted Lithium-Polymer batteries must not be placed with household trash. Please contact local environmental or waste agency or the supplier of your model or your nearest Li-Po battery recycling center.





## Assembling/Disassembling of drone guards

To assemble: each guard must be attached individually. Just press the guard into the slot (near the drone's propellers) from left to right.

To disassemble: gently lift the guard out of the slot moving from left to right.

**Note: Experts & hobbyists may fly without guards for additional power and longer flight times.**

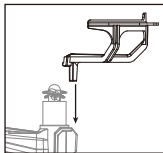

## Assemble/Disassemble the Propellers

To install the propeller, align and snap on the propeller blade to the motor. To disassemble, gently use the plastic fork tool to lift the propeller upward.

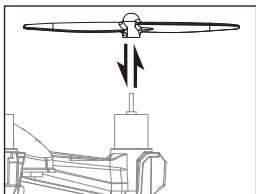

## Additional Instructions of receiver board

The installation direction of the receiver board and the connection position of the welding line must be the same as the following pictures shown so that the drone can work normally. The right front motor line connects to Position 1 of receiver board ; The left front motor line connects to Position 2 of receiver board ; The left rear motor line connects to Position 3 of receiver board ;The right rear motor line connects to Position 4 of receiver board ;

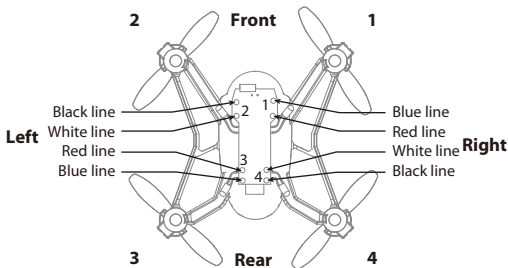

# Check List Before Flight

1. Make sure the Drone and transmitter battery are fully charged.
2. Make sure the Left Stick of the transmitter is in the middle position.
3. Please follow the correct steps to turn on the drone /transmitter. Before flight, turn on the drone, and then the transmitter. After flight, turn off the drone and transmitter. Turning ON/OFF incorrectly may cause the drone to lose control.
4. Make sure to correctly install the battery, motor, etc.
5. Improper operation may cause drone crash, which may cause a motor defect, prevent you from flying, and other issues. Please go to the local distributor to buy new parts for replacement so that the drone will return to its best status.
6. Propellers (A1 & A2) fly clockwise while Propellers (B1 & B2) fly counterclockwise.

## Flight Instruction

### Frequency Pairing

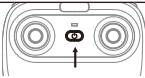
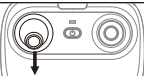
 <p>Power switch (Click)</p>	<p>Turn on the transmitter and the power indicator light flashes rapidly.</p>	 <p>Pull the left stick to the lowest position and then release. The power indicator will flash slowly and the controller is ready for pairing.</p>
--	---	--

Turn on the drone. The drone body lights will stop flashing and turn a solid white color , indicating successful frequency pairing. (Remote Controller sound indication)



**PUT THE DRONE ON  
A FLAT SURFACE!**

### One Button Take Off

After calibration successfully, press this button, the drone will fly up and keep flying at an altitude of approximately 1.2 meters.

### One Button Landing

Press it to land the drone automatically. (In this mode, DO NOT touch the left stick, otherwise it might not work)

### Emergency Landing

In an emergency situation , such as if it is about to hit people or obstacles, press the Take off / Landing / Emergency Stop Button and hold it for more than 1 second. The propellers will stop immediately and the drone will fall.

**Tip: Do not use the emergency stop function unless in emergency situation. The drone will fall down suddenly after all propellers stop.**



## Calibrating The Drone (After Pairing)

Push the right stick as picture shown. (Do not move the left stick before successful calibration), the drone body light will flash 3 times, indicating that drone is calibrating.

After successful calibration, the drone lights will be solid.

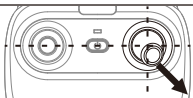

**Tips: Crashing the drone may cause the connection to fail, making the drone hard to control. If this occurs, try repairing and recalibrate .**

## Start/lock the motor

Move the left stick and right stick at the same time 45 degrees inward. (This operation is used for starting/locking the motor. When the motor is working, it could be used to stop the motor urgently.)

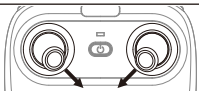

## Flying Control

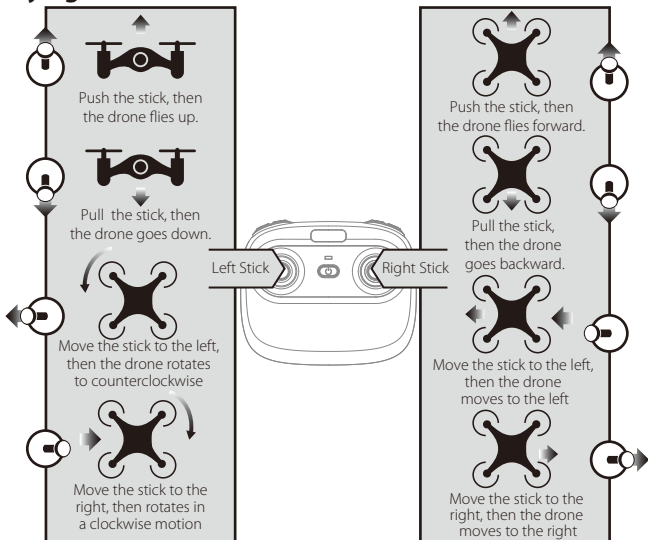

## Trimmer mode

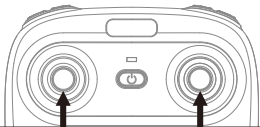

### Forward and backward trimmer

When take off, if the drone tilts forward, press down the trimmer button, and push the right stick backwards. Otherwise push forwards.

### Left and right side flying trimmer

When take off, if the drone tilts to left, then press down the trimmer button and push the right stick backwards to adjust. Otherwise push forwards.

### Left and right turning trimmer

When take off, if the drone head rotates to left, then press down the trimmer button and push the left stick to right. Otherwise push to left.

## Functions Introduction

### Altitude Hold Mode

Intelligent flight control system calculates the hovering position, makes it easier for beginners to control. Release the stick, the drone will keep hovering, capturing clear aerial photos & videos.

**Note: If the propeller is deformed or damaged, Altitude Hold Mode will fail. If the atmospheric pressure is instability or typhoon weather, Altitude Hold Mode will not work well.**

### High / Medium/Low Speed Mode Switch

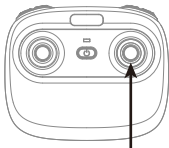

**High / Medium/Low Speed button (press down)**

#### 1. Low Speed Mode (Mode 1)

Low Speed Mode is suitable for beginner.

#### 2. Medium speed Mode (Mode 2)

Medium Speed Mode is suitable for skillful pilots to play in the gentle breeze.

#### 3. High Speed Mode (Mode 3)

High Speed Mode is suitable for experts practicing aerial stunts.

## Headless Mode

Under headless mode, the users can operate the drone without worrying about the orientation (left is left and right is right all the time, regardless of where your drone is pointing at). Headless Mode is designed for beginners, users who fly the drone in daylight or at far distances, or those with difficulty identifying the drone orientation.

### The default setting is NOT Headless Mode.

You can activate the headless mode function before taking off or in flight. Flying under headless mode, your drone direction should be aligned with you. DO NOT change the direction of your transmitter, keep it flying in front of you at all the times. (See below picture).

**WARNING:** ALWAYS ALIGN YOUR DRONE WITH YOUR TRANSMITTER. THE DRONE SHOULD ALWAYS BE IN FRONE OF YOUR TRANSMITTER. OTHERWISE, IT MIGHT LOSE CONTROL OR FLY AWAY.

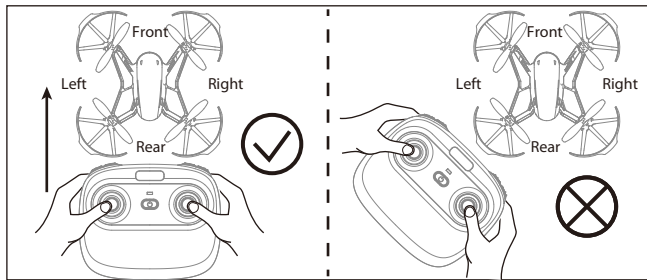

\*Press the Headless Mode button. The drone's LED lights will flash alternatively, indicating that the drone has entered Headless Mode. To turn off Headless Mode, press the Headless Mode button again. The drone's LED lights turn solid, indicating that Headless Mode is off.

Headless Mode



## Low Battery Alarm

When the transmitter or drone has a low battery, It will beep to remind the user to land the drone or replace the batteries as soon as possible.

## Out of Range Alarm

When the drone is out of range or almost at the max remote control distance, it will beep to alert the user to fly back ASAP.

## Motors Stuck Protection

1. When the propellers get stuck, then the drone LED will flash quickly and activate stuck protection function and the motors stop running.
2. Pull down the left stick to the lowest position, the drone LED will become a solid color and stuck protection will be released and the drone can fly again.

### Important Notice

Our company's products are improving all the time, design and specifications are subject to change without notice. All the information in this manual has been carefully checked to ensure accuracy, if any printing errors, our company reserve the final interpretation right.

## Spare Parts (Sold separately)

These are the components for choice below. For your convenient purchase, now we list each part for you, you can purchase ones you want from local distributor.



Drone Cover Housing

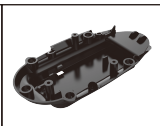

Drone Bottom Housing



A Propeller



B Propeller

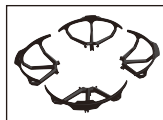

Guard

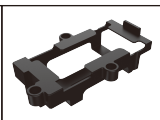

Battery box



Left front LED Cover



Left rear LED Cover



Right front LED Cover



Right rear LED Cover



Cushion



Drone Battery



Clockwise Motor  
(Red and Blue wire)



Counterclockwise Motor  
(Black and White wire)

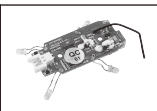

Receiver Board

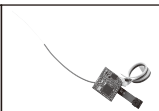

Camera Board



USB charger



Transmitter

## Troubleshooting Guide

No.	Problem	Problem Cause	Solution
1	The transmitter indicator light is off	1. Low battery.	1. Replace the transmitter battery.
		2. The battery positive pole and negative pole are in reverse order.	2. Install the battery in accordance with the user manual.
		3. Poor Connection.	3. Clean the dirt between the battery and the battery slice.
2	Fail to pair the drone with transmitter	1. Indicator light is off.	1. The same as above 1.2.3.
		2. There is interfering signal nearby.	2. Same as 1-3 steps listed above
		3. Mis-operation.	3. Operate the drone step by step in accordance with the user manual.
		4. The electronic component is damaged for frequent crash.	4. To buy spare parts from local seller and replace damaged parts.
3	The drone is under-powered or can not fly.	1. The propeller deformed seriously.	1. Replace the propeller.
		2. Low battery.	2. Recharge the drone battery.
		3. Incorrect installation of propeller.	3. Install the propeller in accordance with the user manual .
		4. The motor is damaged.	4. Replace motor.
4	The drone could not hover and tilts to one side.	1. Improper Calibration.	1. Please refer to the Calibration Instruction.
		2. The propeller deformed seriously.	2. Replace propeller.
		3. The Gyro-sensor did not reset after violent crash.	3. Put the drone on the flat ground for about 10s or restart the the drone to calibrate again.
5	The drone indicator light is off.	1. Low battery.	1. Recharge the drone battery.
		2. The battery is expired or over discharge protection.	2. Buy a new battery from local seller to replace the battery or charge the battery in accordance with the use manual.
		3. Poor Connection .	3.1 Remove and reinsert the battery 3.2 The receiver board may be broken, please go to the local distributor to repair or purchase new parts.

# FCC Note

This equipment has been tested and found to comply with the limits for a Class B digital device, pursuant to Part 15 of the FCC Rules. These limits are designed to provide reasonable protection against harmful interference in a residential installation. This equipment generates uses and can radiate radio frequency energy and, if not installed and used in accordance with the instructions, may cause harmful interference to radio communications. However, there is no guarantee that interference will not occur in a particular installation. If this equipment does cause harmful interference to radio or television reception, which can be determined by turning the equipment off and on, the user is encouraged to try to correct the interference by one or more of the following measures:

- Reorient or relocate the receiving antenna.
- Increase the separation between the equipment and receiver.
- Connect the equipment into an outlet on a circuit different from that to which the receiver is connected.

**WARNING: Changes or modifications not expressly approved by the party responsible for compliance could void the user's authority to operate the equipment.**

## FCC Notice:

The equipment may generate or use radio frequency energy. Changes or modifications to this equipment may cause harmful interference unless the modifications are expressly approved in the instruction manual. Modifications not authorized by the manufacturer may void user's authority to operate this device.

This device complies with Part 15 of the FCC Rules. Operation is subject to the following two conditions:

- (1) This device may not cause harmful interference.
- (2) This device must accept any interference received, including interference that may cause undesired operation.

## FCC Radiation Exposure Statement

The device has been evaluated to meet general RF exposure requirement.  
The device can be used in portable exposure condition with out restriction.

