



### STEP 1

Please go to Apple Store or Google Play to download "WeiView" APP.



### STEP 2

Remove the lid, otoscope auto tune on.

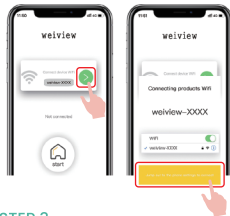

### STEP 3

Click the WiFi connection key to find the WiFi named "WeiView-xxxxx" and connect it.

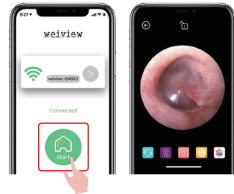

### STEP 4

Return to the App main interface, click the start button to enter the operation interface.

#### Note:

1. After the WiFi connection is successful, the mobile network will not be available.
2. The product has no auto focus function and needs manual focus. The focus range is 10-30mm. You can focus manually by adjusting the distance between the lens and the object to be observed.

**Q1:** Why the lens of the otoscope is hot?

**A1:** It will be a little hot, but you can rest assured that there are relative heat treatments in the lens end to ensure that it will not hurt you. Meanwhile, an equipped a silicone lens cover can isolate the heat from the lens when checking the ear canal.



**Q2:** Why the picture becomes blurred after a period of use?

**A2:** The earwax of most people on the camera lens is oily and can cause glare. Moreover, the earwax will stick to the lens more firmly if not wiped carefully. Please clean the lens carefully with alcohol swab before and after use.

**Note:** The alcohol swab is placed under the inner plastic bracket



**Q3:** Why is the fully charged otoscope will be out of battery after several hours?

**A3:** Perhaps you have switched off the otoscope in the wrong method, as the otoscope will keep in use if the right method is not used. High-end Hall switch technology on the lens makes our otoscope more convenient to use, but you need to pay attention to the right position of the otoscope, please refer to the correct method as follows.

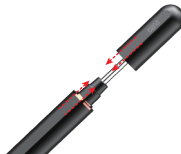

## Sincerely

Thank you for purchasing eutto products.

**If any problems, welcome to contact with us.**

**Manufacturer:**

SHENZHEN DEEPSEA EXCELLENCE TECHNOLOGY CO., LTD

**Address:**

Fourth Layers, 4 Building, Jinhua hair Industrial Park, Sanlian community, Longhua District Longhua Street, Shenzhen, Guangdong, CHINA

**E-mail**

US: support@eutto.com  
UK: support.uk@eutto.com  
JP: support.jp@eutto.com

**Facebook**

@Eutto Official

**Official Website**

www.eutto.com